

Concrete Forma

17 COLOURS / 6 SIZES / 1 FINISH

Concrete Forma is a range of contemporary high-end tiles and wall panels made of UHPC concrete. The collection includes several models possessing the advantage of various laying possibilities. The visual rhythms created by the different line systems define the dynamics of the surface. Breaking the patterns emphasizes the presence of the concrete tiles, making them a dominant element of the space.

Beyond aesthetics, it also serves directing attention and setting focuses like a visual boost for headings, routes for customers, information point, etc. Meanwhile tiles applied in a symmetric system are accommodating into the atmosphere imagined smoothly, supplying a static background to the elements highlighted.

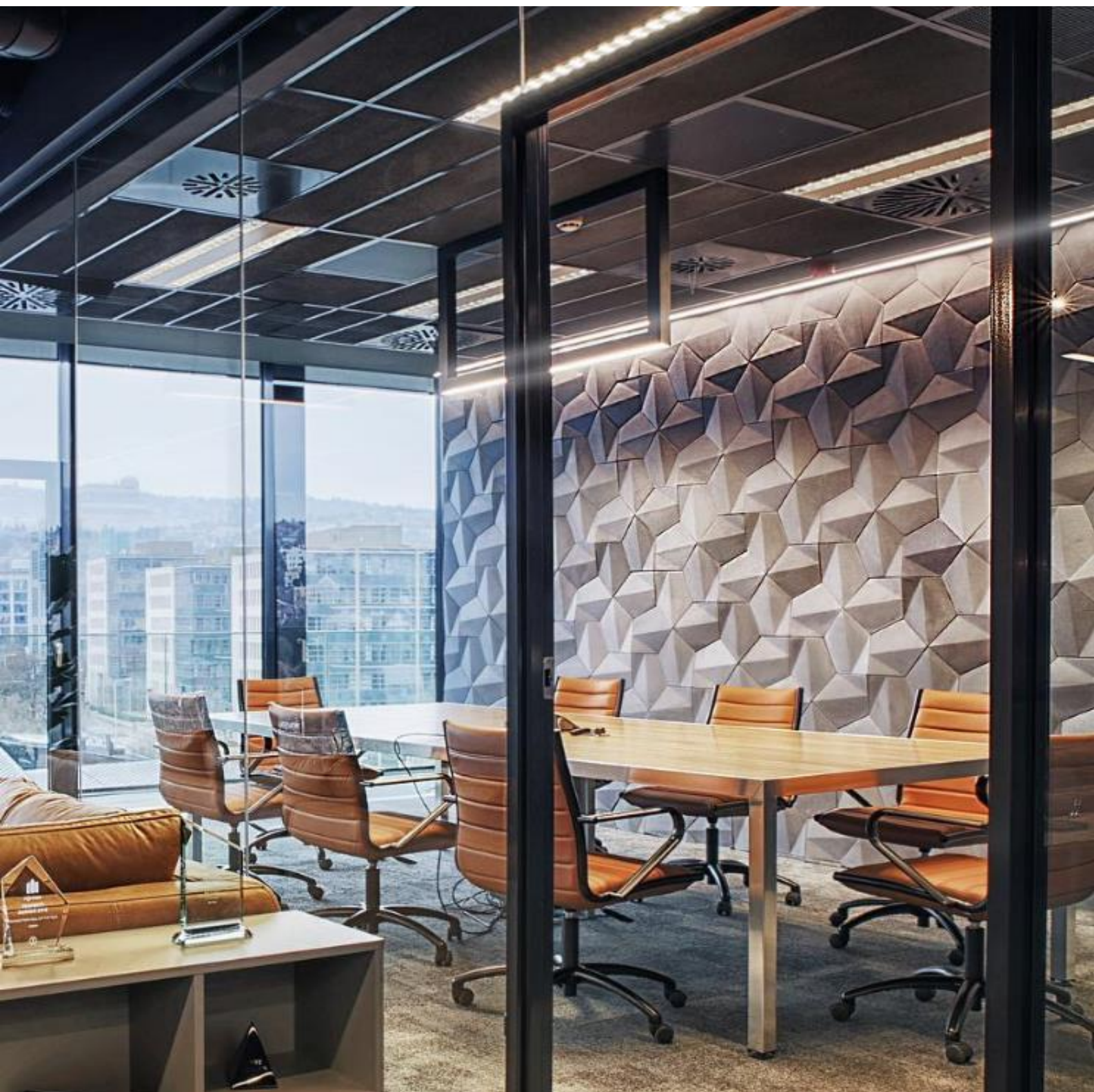

Concrete Forma



Concrete Forma



Concrete Forma



CLOVER

→ 250mm
 ↑ 288mm
 □ 18,5pcs/m2

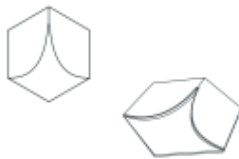

TAZIANO

→ 240 mm
 ↑ 330 mm
 □ 18,3 pcs/m2

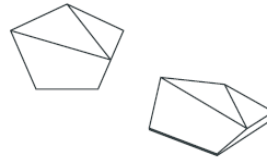

PEACOCK

→ 297mm
 ↑ 278mm
 □ 22,7pcs/m2



PINWHEEL

→ 144mm
 ↑ 250mm
 □ 55,4pcs/m2



TOGETHER

→ 131mm
 ↑ 298mm
 □ 39,4pcs/m2

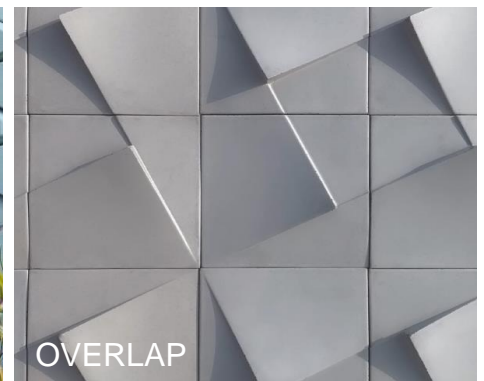
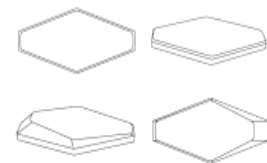

OVERLAP

→ 197mm
 ↑ 197mm
 □ 25,8pcs/m2

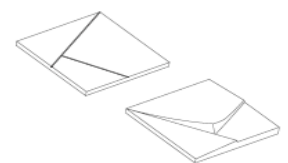

The colour representations shown in this data sheet are as accurate as the limitations of the printing process will allow. Due to the manufacturing process of our floor tiles there may be a small variation in the PTV value. The slip resistance values are correct at the time of testing and represent the standard production value. Inadequate cleaning and maintenance will lead to significant reduction in the slip resistance of any tiles. The pendulum test results have been displayed in line with H&S Executive guidelines whereby 0-24 represents high slip potential, 25-35 moderate slip potential & 36+ represents a low slip potential.

For further information contact: T: 0116 276 2532 – W: www.parkside.co.uk – E: info@parkside.co.uk

Strata Technical Tiles is the partner brand of Parkside Architectural Tiles

Concrete Forma

GROUP - Concrete

	Standard	Requirement	Established Values
Water Absorption	-	-	Ave 4.8 %
Breaking Strength	EN12390-3	-	Ave 1698 (KN)
Wear Resistance Class	EN 1339	Declare Class	4
Compressive Strength	EN 12390-3	-	Ave 79.8 (N/mm2)
Reaction to Fire	-	Class A1 A1/FL	Class A1
Density	EN 12390-3	-	Ave 2330 (kg/m3)

Recycled Content	0 %
Range Name	Concrete Forma

The colour representations shown in this data sheet are as accurate as the limitations of the printing process will allow. Due to the manufacturing process of our floor tiles there may be a small variation in the PTV value. The slip resistance values are correct at the time of testing and represent the standard production value. Inadequate cleaning and maintenance will lead to significant reduction in the slip resistance of any tiles. The pendulum test results have been displayed in line with H&S Executive guidelines whereby 0-24 represents high slip potential, 25-35 moderate slip potential & 36+ represents a low slip potential.

For further information contact: T: 0116 276 2532 – W: www.parkside.co.uk – E: info@parkside.co.uk

Strata Technical Tiles is the partner brand of Parkside Architectural Tiles